

STUDENT INFORMATION BOOKLET

2024-2025 Academic Year



ALL STUDENTS ACCEPTED TO THE RRIS MUST READ THIS BOOKLET AND SHARE THE INFORMATION WITH THEIR FAMILIES.

CONGRATULATIONS ON YOUR ACCEPTANCE TO THE RAPHAEL RECANATI INTERNATIONAL SCHOOL IN REICHMAN UNIVERSITY!

[Home Page](#)

[Welcome](#)

[Preparatory Courses](#)

[Orientation Week](#)

[Ulpan](#)

[Reichman University Dormitories](#)

[Health Insurance](#)

[Visa Information](#)

[Living in Israel](#)

[Terms of Payment and Fees](#)

[Scholarships and Financial Aid](#)

[Study Skills Center / Psych. Counseling](#)

[Contact Info](#)

[Academic Calendar](#)

[Final Checklist](#)

- You are about to embark on one of the most significant experiences of your life. Reichman University (RUNI) is a dynamic learning community that fosters creativity and innovation and promotes the development of new opportunities inside and outside the classroom.
- This booklet contains essential information regarding your studies at the RRIS and will assist you in making decisions prior to your arrival.
- We are here to help make your student experience the best that it can be.



WHAT'S NEXT?

[Home Page](#)

[Welcome](#)

[Preparatory Courses](#)

[Orientation Week](#)

[Ulpan](#)

[Reichman University Dormitories](#)

[Health Insurance](#)

[Visa Information](#)

[Living in Israel](#)

[Terms of Payment and Fees](#)

[Scholarships and Financial Aid](#)

[Study Skills Center / Psych. Counseling](#)

[Contact Info](#)

[Academic Calendar](#)

[Final Checklist](#)

1

Read the information in this booklet carefully as it provides answers to your questions.

2

Update your personal details in the [candidate information station](#).

3

Confirm your acceptance by logging in to your [candidate information station](#) and paying the \$1,000 USD enrollment deposit (which will be credited towards your annual tuition payment).

*Share the important information in this booklet with your family



A WELCOME FROM THE HEAD OF THE SCHOOL

[Home Page](#)

[Welcome](#)

[Preparatory Courses](#)

[Orientation Week](#)

[Ulpan](#)

[Reichman University Dormitories](#)

[Health Insurance](#)

[Visa Information](#)

[Living in Israel](#)

[Terms of Payment and Fees](#)

[Scholarships and Financial Aid](#)

[Study Skills Center / Psych. Counseling](#)

[Contact Info](#)

[Academic Calendar](#)

[Final Checklist](#)

Please allow me to welcome you to our lovely campus and university. It is my hope that each of you excel in your academic studies during your time with us. We are here to provide you with the best tools we can offer so that in just a few years, we can meet you at graduation in your caps and gowns, on your way to achieving your professional goals. This year we are blessed with an impressive intake of undergraduate and graduate students.

One of our most important aims, in addition to providing you with a stimulating academic environment, is to offer you an opportunity for acculturation and integration at Reichman University and in the State of Israel. Please indulge in as many extra-curricular activities as possible during your time here. Among these are the Debate Club, Entrepreneurship Club, the Model UN, JLIC, RRIS hiking, biking, overnight field trips, AEPi, RUNI Radio, the Ambassadors' Club, the dance troupe, band or choir, festival celebrations, RUNI Talent, and so much more. Hopefully, the careful balance between your academic studies and extra-curricular activities will provide you with an enriching and well-rounded education, as well as dozens of friends for life and networks that will serve you even decades from now, when you have become veterans of your places of work and have raised beautiful families.

The dedicated staff of the Raphael Recanati International School is here to help solve any problems you may encounter, both on and off campus, to the best of our ability. Please do not hesitate to call us and let us know what's on your mind. Consider us your family here in Israel. I look forward to meeting each and every one of you - please do not hesitate to approach me!

Wishing all of you the best possible time at Reichman University.

Jonathan Davis

Vice President for External Relations
Head, Raphael Recanati International School



WELCOME FROM THE RRIS DIRECTOR

[Home Page](#)

[Welcome](#)

[Preparatory Courses](#)

[Orientation Week](#)

[Ulpan](#)

[Reichman University Dormitories](#)

[Health Insurance](#)

[Visa Information](#)

[Living in Israel](#)

[Terms of Payment and Fees](#)

[Scholarships and Financial Aid](#)

[Study Skills Center / Psych. Counseling](#)

[Contact Info](#)

[Academic Calendar](#)

[Final Checklist](#)

Shalom and welcome to the RRIS!

On behalf of Reichman University Raphael Recanati International School, it is my privilege to welcome you among our ranks. With international students hailing from over 90 countries around the world, the RRIS prides itself on embracing the various cultures that have come together in Reichman University's "melting pot" spirit.

Reichman University is a leading academic institution that aims to be a center of global excellence. We are unique in our educational methods, which are based on an interdisciplinary approach. We combine theory with real world experience and provide our students with cultural and professional proficiencies.

At the RRIS we educate talented young people to influence and contribute in every arena in which they choose to integrate, in Israel and worldwide. Our basic outlook, which is rooted in the twin concepts of individual freedom and responsibility, emphasizes student entrepreneurship and leadership alongside commitment to community service.

Our staff is devoted to making you feel at home, be attentive and respond to your every need. We wish you abundant success on your way to fulfill your academic goals.

All the best,

Carine Katz

Director

Raphael Recanati International School, Reichman University



PREPARATORY COURSES

[Home Page](#)

[Welcome](#)

[Preparatory Courses](#)

[Orientation Week](#)

[Ulpan](#)

[Reichman University Dormitories](#)

[Health Insurance](#)

[Visa Information](#)

[Living in Israel](#)

[Terms of Payment and Fees](#)

[Scholarships and Financial Aid](#)

[Study Skills Center / Psych. Counseling](#)

[Contact Info](#)

[Academic Calendar](#)

[Final Checklist](#)

The RRIS offers preparatory courses in Mathematics, English and Programming. Please refer to your admissions letter to determine if you are required to participate in one or more of the preparatory courses, which take place during the months of August-September 2024.

PREPARATORY ENGLISH COURSE

Based on previous studies and level of English proficiency (demonstrated on an English proficiency exam), candidates may be required to participate in an English language preparatory course (English Mechina). This course is designed to prepare non-native speakers for academic studies in English. Please refer to your acceptance letter to determine whether you are required to participate in this course.

Length of the course:

33 academic hours (11 sessions)

Dates of the course:

The course will take place in a hybrid manner from September 1, 2024 until September 25, 2024.

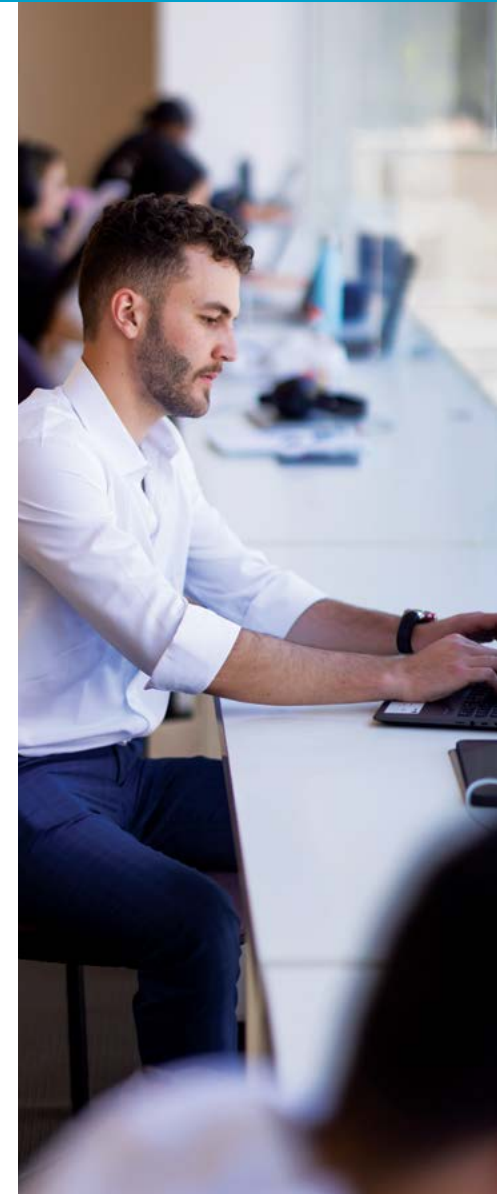

PREPARATORY COURSES

[Home Page](#)

[Welcome](#)

[Preparatory Courses](#)

[Orientation Week](#)

[Ulpan](#)

[Reichman University Dormitories](#)

[Health Insurance](#)

[Visa Information](#)

[Living in Israel](#)

[Terms of Payment and Fees](#)

[Scholarships and Financial Aid](#)

[Study Skills Center / Psych. Counseling](#)

[Contact Info](#)

[Academic Calendar](#)

[Final Checklist](#)

PREPARATORY MATH COURSE FOR BUSINESS

Applicants who have been admitted to the BA program in Business Administration, the double major program in Business Administration and Economics, the double major program in Entrepreneurship and Economics with Data Science or the double major program in Entrepreneurship and Business, will likely be required to participate in a Mathematics preparatory course. Applicants are required to refer to their acceptance letter to determine if they are required to participate in this course.

Course topics:

- Basic algebraic operations
- Algebraic identities
- Solving equations and inequalities
- Linear and quadratic functions
- The Cartesian coordinate system (the xy-plane)
- Logarithms and exponents: basic techniques and equations
- Differentiation techniques and applications of the derivative
- Limits of functions
- Graphing functions
- Arithmetic and geometric sequences

We strongly recommend that students review the subjects listed above as some previous knowledge is assumed in these subjects.

Length of the course:

80 academic hours (15 sessions)

The course will take place in a hybrid manner from August 27, 2024 until September 26, 2024.

[Home Page](#)

[Welcome](#)

[Preparatory Courses](#)

[Orientation Week](#)

[Ulpan](#)

[Reichman University Dormitories](#)

[Health Insurance](#)

[Visa Information](#)

[Living in Israel](#)

[Terms of Payment and Fees](#)

[Scholarships and Financial Aid](#)

[Study Skills Center / Psych. Counseling](#)

[Contact Info](#)

[Academic Calendar](#)

[Final Checklist](#)

PREPARATORY COURSES

PREPARATORY COURSES FOR COMPUTER SCIENCE

MATHEMATICS REFRESHER COURSE FOR COMPUTER SCIENCE

We offer our applicants an online refresher course to bridge the gap between their high school mathematics and university mathematics. The course may also be used as a condition for enrolling in the mandatory preparatory course, in cases where applicants do not meet the program admissions requirements. Such applicants will be required to attend the refresher course and pass its final exam. Students who do not achieve a passing grade in the final exam will not be permitted to continue to the mandatory preparatory course or enroll in the BSc degrees.

Course topics:

- Basic algebra equations
- Arithmetic sequences
- Geometric sequences
- Trigonometric identities
- Functions

Length of course: 50 academic hours (10 sessions)

Dates of the course: July 22- August 7 2024

The course will be conducted online via zoom

Dates are subject to change.



PREPARATORY COURSES

[Home Page](#)

[Welcome](#)

[Preparatory Courses](#)

[Orientation Week](#)

[Ulpan](#)

[Reichman University Dormitories](#)

[Health Insurance](#)

[Visa Information](#)

[Living in Israel](#)

[Terms of Payment and Fees](#)

[Scholarships and Financial Aid](#)

[Study Skills Center / Psych. Counseling](#)

[Contact Info](#)

[Academic Calendar](#)

[Final Checklist](#)

PREPARATORY MATH COURSE

Applicants who have been admitted to the BSc program in Computer Science or the Double Major program in Entrepreneurship & Computer Science, will likely be required to pass a Mathematics preparatory course for Computer Science. Applicants are required to refer to their acceptance letter to determine if they are required to pass this course in order to officially enroll in the School of Computer Science.

Course Topics:

- **Equations of one or two variables**
- **Linear equations**
- **Quadratic equations**
- **Equation of a higher degree**
- **Equations with parameters**
- **Equations with radicals**
- **Polynomial division**
- **Inequalities (linear, quadratic, higher degree, with quotients, with absolute value, "and/or" systems)**
- **Exponents and logarithms (properties, equations and inequalities)**
- Basic functions: Linear and quadratic
- Sequences (arithmetic, geometric, recursive)
- Complex numbers
- Limits
- Derivatives (definition, application)
- Function investigation: Polynomials; Rational functions; Radicals; Exponential and logarithmic functions including parametric problems
- Trigonometric identities and equations

Length of the course: 100 academic hours (17 sessions)

The course will take place in a hybrid manner from August 18, 2024 until September 26, 2024.

Exam Dates:

- **First Session:** September 26th, 2024, 3:45 PM (Israel time)
- **Second Session:** October 9th, 2024, 3:45 PM (Israel time)

* There are two exam sessions for the Computer Science Math Preparatory Course. A third exam sessions will not be given under any circumstances.

PREPARATORY COURSES

[Home Page](#)

[Welcome](#)

[Preparatory Courses](#)

[Orientation Week](#)

[Ulpan](#)

[Reichman University Dormitories](#)

[Health Insurance](#)

[Visa Information](#)

[Living in Israel](#)

[Terms of Payment and Fees](#)

[Scholarships and Financial Aid](#)

[Study Skills Center / Psych. Counseling](#)

[Contact Info](#)

[Academic Calendar](#)

[Final Checklist](#)

PREPARATORY PROGRAMMING COURSE

The purpose of the course is to provide participants with basic programming skills and to prepare them for the course "Introduction to Computer Science," which is offered in the Fall semester. This preparatory course is an introductory course that requires no prior knowledge or background in programming, but the fundamental topics are studied at a fast pace. Participation in the course is mandatory.

Course topics:

- Basic data types
- Variables
- Logic and arithmetic expressions
- Control structures (if, while, for)
- One-dimensional arrays
- Writing, documentation, and testing computer programs in Java

Length of the course: 40 academic hours (10 sessions)

The course will take place in a hybrid manner from August 18, 2024 until September 11, 2024.



ORIENTATION WEEK

[Home Page](#)

[Welcome](#)

[Preparatory Courses](#)

[Orientation Week](#)

[Ulpan](#)

[Reichman University
Dormitories](#)

[Health Insurance](#)

[Visa Information](#)

[Living in Israel](#)

[Terms of Payment
and Fees](#)

[Scholarships and
Financial Aid](#)

[Study Skills Center /
Psych. Counseling](#)

[Contact Info](#)

[Academic Calendar](#)

[Final Checklist](#)

The academic year begins with Orientation Week on Sunday, **October 27, 2024.**

One of the innovative and important services that Reichman University (RUNI) provides to its students is a week-long orientation for first-year students. Orientation Week is designed to make first year students' entry into the academic environment as smooth as possible.

Orientation Week is vital preparation for succeeding at RUNI. **Participation is mandatory.**

Each incoming student is assigned a *chonech*, a peer counselor (2nd or 3rd year Israeli student) who is tasked with helping new students acculturate to RUNI and to Israel. Your peer counselor will accompany you from your arrival to campus throughout your first year at RUNI. Your counselor will contact you shortly before your arrival to campus (either for the preparatory courses or Orientation Week).

Orientation Week includes five full days of orientation to RUNI, your peers and your new home in Israel. In order to be prepared to begin studies and have the tools to access our online and social communities, your presence is mandatory.

[Orientation Trip Movie >>](#)

The week will include:

Academic Orientation: meet the dean of your school, consult with your academic advisor regarding class assignment and selection, and participate in introductory lectures and conversations.

Technical Orientation: receive your student ID card, learn how to access your email, use the online student portal (essential for class registration, email, grade access, and other key functions).

Social Orientation: sign up for RUNI's extracurricular activities (clubs, sports, societies, etc.), engage with the local community via volunteering opportunities, meet and bond with your peers as we engage in structured discussions and travel to the desert for an excursion including hikes, team building, and lots of fun.



ORIENTATION WEEK

[Home Page](#)

[Welcome](#)

[Preparatory Courses](#)

[Orientation Week](#)

[Ulpan](#)

[Reichman University Dormitories](#)

[Health Insurance](#)

[Visa Information](#)

[Living in Israel](#)

[Terms of Payment and Fees](#)

[Scholarships and Financial Aid](#)

[Study Skills Center / Psych. Counseling](#)

[Contact Info](#)

[Academic Calendar](#)

[Final Checklist](#)

Sample Orientation Week schedule for your reference, subject to changes

Sunday	Monday	Tuesday	Wednesday	Thursday
8:30 Registration and extracurricular fair	9:00 Orientation group gathering		9:00 Student Portal: Technical Orientation	
10:00 Orientation group gathering	10:00 Library orientation and campus tour, student cards	10:00 MASA Meeting	10:00 Workshop	
11:30 RUNI Unique learning experience	11:30 Guest lecture & Lunch	10:00 <i>Minhal Ha-Studentim</i> Meeting	12:00 Opening Ceremony by school	
13:30 Meet your dean: academic orientation	14:30 RRIS Student Affairs Department	11:30 Health Insurance Info session	14:30 Student & alumni panel	RRIS Orientation Trip
15:00 RRIS Welcome Ceremony	15:30 RUNI Ethics	14:00 <i>Ulpan</i> placement test	15:30 Intro to campus Psychological services, Student Union and Study Skills Center	
16:00 Student Clubs Fair			17:00 Orientation group gathering	
			18:00 Student union activity - all campus	

ELECTIVE HEBREW COURSE *ULPAN*

[Home Page](#)

[Welcome](#)

[Preparatory Courses](#)

[Orientation Week](#)

[Ulpan](#)

[Reichman University
Dormitories](#)

[Health Insurance](#)

[Visa Information](#)

[Living in Israel](#)

[Terms of Payment
and Fees](#)

[Scholarships and
Financial Aid](#)

[Study Skills Center /
Psych. Counseling](#)

[Contact Info](#)

[Academic Calendar](#)

[Final Checklist](#)

Learning Hebrew is essential to your acculturation in Israel. RUNI offers Hebrew *ulpan* (Hebrew language studies during the academic year) at five different levels so you may improve your Hebrew AND get two general elective credits for it!

To join the yearlong *ulpan* general elective course, you will need to take a Hebrew placement test after which you will be divided into classes based on your test results. Classes are designed to help students feel comfortable using Hebrew.

The placement test for the *ulpan* will be held during Orientation Week for all interested students.

Online registration for the course will take place during the first two weeks of the academic year.

INTENSIVE ACADEMIC SUMMER HEBREW *ULPAN*

RUNI is home to an annual five-week intensive summer *ulpan* in July and August. This is an academic *ulpan* and participants who attend the entire six weeks of classes will be awarded a certificate of completion from the Ministry of Education*.

There is an additional fee for participating in the summer *ulpan*. Please note that there are no dormitory arrangements during the *ulpan* and it is not part of the academic curriculum.

* Students at the summer *ulpan* do not earn academic credits from Reichman University.

For more details regarding the summer *ulpan* please contact ulpanrris@runi.ac.il

REICHMAN UNIVERSITY DORMITORIES

[Home Page](#)

[Welcome](#)

[Preparatory Courses](#)

[Orientation Week](#)

[Ulpan](#)

[Reichman University
Dormitories](#)

[Health Insurance](#)

[Visa Information](#)

[Living in Israel](#)

[Terms of Payment
and Fees](#)

[Scholarships and
Financial Aid](#)

[Study Skills Center /
Psych. Counseling](#)

[Contact Info](#)

[Academic Calendar](#)

[Final Checklist](#)

To experience university life in the best way, nothing equals living on campus where students can enjoy convenience and a sense of community. In the 2024- 2025 academic year RUNI students will have the option of enjoying the high standard of living offered in the 748 fully equipped residential units located in three 12-story towers on RUNI's campus.

The dormitory towers were planned and designed to meet green building standards where students have many opportunities for interaction which contributes to their academic success and personal growth. The facilities include fully equipped study halls to enable students to focus on their studies and to maintain a diverse social life. Each building also has laundry rooms with washing machines and dryers at the residents' disposal, in addition to a Shabbat elevator and a synagogue in the Recanati building.

The apartments are available to all students pursuing undergraduate and master's degrees at RUNI. The dorms include apartments for single students, married couples (both RUNI students), and accessible units for students with disabilities.

The rent includes Wi-Fi, TV services (cable), building fees, maintenance, gardening, cleaning of common areas, and 24/7 security services on the premises; It does not include electricity and water fees.



REICHMAN UNIVERSITY DORMITORIES

[Home Page](#)

[Welcome](#)

[Preparatory Courses](#)

[Orientation Week](#)

[Ulpan](#)

[Reichman University Dormitories](#)

[Health Insurance](#)

[Visa Information](#)

[Living in Israel](#)

[Terms of Payment and Fees](#)

[Scholarships and Financial Aid](#)

[Study Skills Center / Psych. Counseling](#)

[Contact Info](#)

[Academic Calendar](#)

[Final Checklist](#)

All apartments, except for the units for married couples, are designated for one student per unit. The apartments are furnished to accommodate all residents' needs: Every apartment has an air conditioning unit, a private bathroom with shower, a bed (120cm/190cm for which linen is not included), and a kitchen area. The kitchen is fully equipped with a refrigerator, electric cooking top, microwave, and an electric kettle. In addition, the apartment includes a desk, closet, TV, a dining table and chairs.

The rental fee for a single unit is \$950 USD per month.

The contract period for students who wish to reside in a RUNI dormitory suite begins on the day the student moves into the suite and ends on September 30th, 2025.

For information, please see the Dormitories website and contact the Dorms Coordinator at dorms@runi.ac.il

[RUNI DORMITORIES clip >>](#)

Single Units

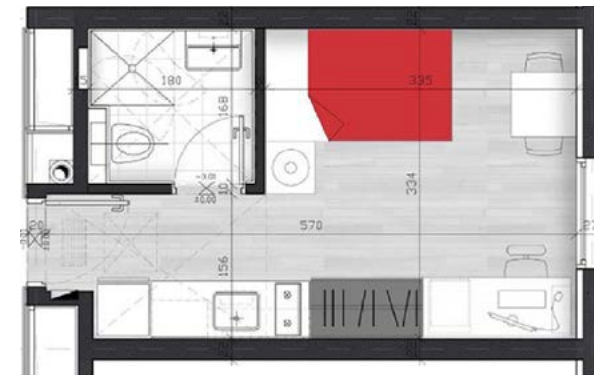

The single units are approximately 20 square meters.

The image is for illustrative purposes only.

HEALTH INSURANCE

All Reichman University students are required to have comprehensive health insurance coverage throughout the duration of their studies. Reichman University cannot cover medical costs or take responsibility for students who do not have insurance.

You may purchase your own health insurance policy to cover your medical needs while in Israel, or purchase the UMS HAREL YEDIDIM insurance policy for international students, offered by **Reichman University (RUNI)**. If you are an Israeli resident covered by Israel's National Health Insurance (*Bituach Leumi*), you do not need any additional health insurance.

The insurance plan with HAREL YEDIDIM provides comprehensive health coverage for *\$1600 USD per academic year, which will be charged at the beginning of the year. Please see the next page for policy details.

The insurance policy will start on **October 20, 2024**.

Insurance start date for preparatory course students will be earlier, **for an additional charge**, as follows:

- for students taking preparatory courses for Computer Science or Business beginning on August 18 or 20, the insurance policy will start on August 11, 2024 (\$300 USD extra)
- for students taking other preparatory courses beginning on September 1, the insurance policy will start on August 25, 2024 (\$250 USD extra)

The end date of the insurance policy for all students will be **August 31, 2025**.

In order for students to have continuous coverage, the HAREL YEDIDIM policy will be automatically renewed from one academic year to the next, until the end of the program, unless the student notifies the school in writing that he/she has an alternative health insurance and wishes to cancel.

Please note that the HAREL YEDIDIM health insurance plan does not cover pre-existing conditions.



[Home Page](#)

[Welcome](#)

[Preparatory Courses](#)

[Orientation Week](#)

[Ulpan](#)

[Reichman University Dormitories](#)

[Health Insurance](#)

[Visa Information](#)

[Living in Israel](#)

[Terms of Payment and Fees](#)

[Scholarships and Financial Aid](#)

[Study Skills Center / Psych. Counseling](#)

[Contact Info](#)

[Academic Calendar](#)

[Final Checklist](#)

[Home Page](#)

[Welcome](#)

[Preparatory Courses](#)

[Orientation Week](#)

[Ulpan](#)

[Reichman University
Dormitories](#)

[Health Insurance](#)

[Visa Information](#)

[Living in Israel](#)

[Terms of Payment
and Fees](#)

[Scholarships and
Financial Aid](#)

[Study Skills Center /
Psych. Counseling](#)

[Contact Info](#)

[Academic Calendar](#)

[Final Checklist](#)

IN ORDER TO REGISTER FOR HEALTH INSURANCE THROUGH RUNI YOU MUST:

1. Log in to your [Candidate Information Station](#) and check YES for insurance on the Status & Insurance section.
2. Fill out the health declaration, which will be sent to you six weeks before the beginning of the insurance, as required by "Harel Yedidim". Without this declaration the policy cannot be issued.

Medication:

If you are taking prescribed medication it is advised to bring an adequate supply for at least the first few months until you can set up care in Israel. If that is not possible, you should bring a doctor's prescription (clearly typed in English) for the medicine that you are using, or a prescription of a generic medication that is suitable for your condition. It will have to be translated by an Israeli doctor in order to purchase it in a pharmacy in Israel.

National Health Insurance (*Bituach Leumi*) for Israeli residents:

All Israeli residents who are registered for National Health Insurance (*Bituach Leumi*) including new immigrants (*olim chadashim*) are entitled to receive National Health Insurance for a low monthly fee. New immigrants who are not employed are entitled to twelve months of free national health insurance.

***The HAREL YEDIDIM yearly rate of \$1600 USD is subject to change from year to year according to insurance company rate fluctuations. A notice about any rate change will be updated in the website in advance.**

For questions regarding insurance email rris.insurance@runi.ac.il



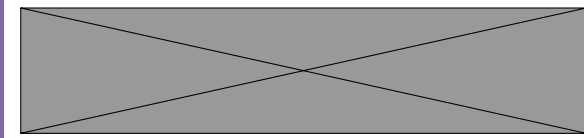

HEALTH INSURANCE FOR REICHMAN UNIVERSITY STUDENTS

[Home Page](#)

[Welcome](#)

[Preparatory Courses](#)

[Orientation Week](#)

[Ulpan](#)

[Reichman University Dormitories](#)

[Health Insurance](#)

[Visa Information](#)

[Living in Israel](#)

[Terms of Payment and Fees](#)

[Scholarships and Financial Aid](#)

[Study Skills Center / Psych. Counseling](#)

[Contact Info](#)

[Academic Calendar](#)

[Final Checklist](#)

HAREL Insurance & Finance Ltd., Israel's leading firm in health insurance, and "YEDIDIM", which serve thousands of students in Israel, have joined together to create an overall insurance protection program, providing for your health care needs. The medical services are provided by the **Clalit Healthcare** providers throughout Israel. Clalit and Harel operate a Call Center in English and in Hebrew 24/7. The medical coverage is based on the UMS - University Medical Services Policy. All costs are quoted in US dollars.

OUTLINE OF THE UMS POLICY

Coverage Item

- Overall coverage for insurance period
- Maximum period of hospitalization
- Visit to doctor & specialist
- Visit to doctor who does not have an arrangement with the Clalit
- Laboratory tests, x-rays, etc. with no ceiling
- Medicine in the health service basket at the Clalit pharmacies, according to doctor's prescription
- Emergency dental treatment
- Assistance for flight to country of origin due to medical problem, subject to approval of Harel's medical board
- Transport of mortal remains to home country
- House calls by a physician 24/7

UMS

\$100,000.-
 Up to 90 days
 Included, No co-pay
 -
 Only at Clalit Laboratories
 Included, No co-pay
 At Clalit Smile Clinics
 Up to \$10,000.-
 Up to \$5,000.-
 Included, no co-pay



HEALTH INSURANCE FOR REICHMAN UNIVERSITY STUDENTS

[Home Page](#)

[Welcome](#)

[Preparatory Courses](#)

[Orientation Week](#)

[Ulpan](#)

[Reichman University Dormitories](#)

[Health Insurance](#)

[Visa Information](#)

[Living in Israel](#)

[Terms of Payment and Fees](#)

[Scholarships and Financial Aid](#)

[Study Skills Center / Psych. Counseling](#)

[Contact Info](#)

[Academic Calendar](#)

[Final Checklist](#)

Exclusions:

- Incidents related to alcohol ingestion and/or illegal drug use.
- Pre-existing medical conditions
- Dental treatment
- Pregnancy and/or delivery
- Psychiatric and psychological care, including ADHD etc.
- The insurance is valid **only in the State of Israel***

Note: Infectious diseases, AIDS and sexually transmitted diseases, system-wide problems and cancer in the treatment stage require a separate, private insurance policy.

* If you are traveling outside of Israel, it is recommended to purchase an additional short term travel insurance for the period of time abroad.

Harel Yedidim Insurance Company also offers various plans for Home Insurance, including laptop & other valuables, and third party liability insurance.

For details about Home Insurance: Email - y_health@yedidim.co.il

DISCLAIMER

REICHMAN UNIVERSITY TAKES NO RESPONSIBILITY FOR THE QUALITY OR THE CONSEQUENCES OF SERVICES RENDERED BY THIS COMPANY. REICHMAN UNIVERSITY ACTS IN THE CAPACITY OF OBJECTIVE RECOMMENDER ONLY.



VISA & STATUS INFORMATION

[Home Page](#)

[Welcome](#)

[Preparatory Courses](#)

[Orientation Week](#)

[Ulpan](#)

[Reichman University Dormitories](#)

[Health Insurance](#)

[Visa Information](#)

[Living in Israel](#)

[Terms of Payment and Fees](#)

[Scholarships and Financial Aid](#)

[Study Skills Center / Psych. Counseling](#)

[Contact Info](#)

[Academic Calendar](#)

[Final Checklist](#)

Students are responsible for clarifying and establishing their status in Israel and can turn to the Raphael Recanati International School staff for advice and assistance. Israeli visa requirements vary based on your country of citizenship. A student visa must be issued **in advance before your arrival to Israel, through the nearest Israeli consulate**. Please contact the nearest Israeli embassy / consulate for information regarding the exact procedure. Information for Israeli embassies and consulates around the world can be found [here](#).

The RRIS staff is here to help with the procedure and can provide students with certification of your status as an accepted student.

STUDENT VISA (A2):

A student visa is a multiple entry visa valid for one year after which time it can be renewed. To apply for a student visa you will likely be asked to provide:

- Passport valid for at least one year after required stay
- Letter of acceptance to Reichman University
- Visa application form (2 copies)
- Photographs (2)
- Visa fee
- Birth Certificate
- Proof of financial means to pay for studies and sustenance throughout stay in Israel
- Proof of health insurance to cover you in Israel, including COVID-19

Note: The Consul may request additional documents.

RETURNING ISRAELI

Students who were born in Israel must contact the nearest Israeli Consulate for updated information. Regulations regarding this population change frequently.

NEW IMMIGRANT (*oleh chadash*)

You must check your **Israel Defense Forces (IDF) status**. In general, you might need to serve in the army (this depends on your age upon arrival in Israel) but may be able to defer your service until after you graduate. The Jewish Agency provides advice and assistance to students considering immigrating to Israel. For more information click [here](#). Contact and information for North America/UK can be found [here](#).

STUDENTS WHO HAVE AT LEAST ONE ISRAELI PARENT

Contact the nearest Israeli Consulate to check your Israeli Defense Forces (IDF) status, and to obtain an Israeli passport in order to enter and stay in Israel. Request a status of "child of emigrants" (*b'nei mehagrim*) from your local Israel Consulate. You may be eligible for a special status from the IDF as long as you are a student. For more details contact Shelly Levy at levys@runi.ac.il. Information for Israeli embassies and consulates around the world can be found [here](#).

LIVING IN ISRAEL

[Home Page](#)

[Welcome](#)

[Preparatory Courses](#)

[Orientation Week](#)

[Ulpan](#)

[Reichman University Dormitories](#)

[Health Insurance](#)

[Visa Information](#)

[Living in Israel](#)

[Terms of Payment and Fees](#)

[Scholarships and Financial Aid](#)

[Study Skills Center / Psych. Counseling](#)

[Contact Info](#)

[Academic Calendar](#)

[Final Checklist](#)

Moving to Israel can be exciting and challenging. A guide with basic information about banking, internet set up, transportation, mobile phones, etc., can be found in the [Counselor's Tip-Book](#).

SOCIAL & CULTURAL ACTIVITIES AT THE RRIS

The RRIS organizes a wide variety of social and cultural activities for all the students on campus in English!

Throughout the academic year the school hosts cultural events, performances, educational tours, social gatherings and more. For information about our extracurricular activities at the RRIS please visit our [website](#) page, on  and .

E-MAIL

RUNI E-mail Account:

During Orientation Week you will receive an RUNI e-mail account. RUNI e-mail addresses are usually in the following format:

firstname.lastname@post.runi.ac.il

Please note that this e-mail account is our primary form of contact with you and you are expected to check it on a regular basis. There are many computers available on campus and there are wireless hot spots in every building on campus.



TERMS AND PAYMENTS

[Home Page](#)

[Welcome](#)

[Preparatory Courses](#)

[Orientation Week](#)

[Ulpan](#)

[Reichman University Dormitories](#)

[Health Insurance](#)

[Visa Information](#)

[Living in Israel](#)

[Terms of Payment and Fees](#)

[Scholarships and Financial Aid](#)

[Study Skills Center / Psych. Counseling](#)

[Contact Info](#)

[Academic Calendar](#)

[Final Checklist](#)

TUITION, FEES AND TERMS OF PAYMENT 2024-2025 1st Year Undergraduate Degrees Students

TUITION AND EXPENSES*

	<ul style="list-style-type: none"> • Business Administration • Government • Government and Sustainability • Business and Economics 	<ul style="list-style-type: none"> • Communications • Computer Science • Entrepreneurship and Computer Science • Entrepreneurship and Business • Entrepreneurship and Economics with Data Science • Psychology
Tuition for the 2024-2025 academic year	\$15,900	\$16,200
Optional: Health Insurance**	\$1,600	\$1,600
Optional: Student Union Fee***	\$60	\$60
Total	\$17,560	\$17,860

TUITION PAYMENT ARRANGEMENTS

In order to reserve a place in the class, a \$1,000 tuition down payment must be sent to the Reichman University Tuition Department according to the instructions specified in the acceptance letter. The down payment is the first annual tuition payment.

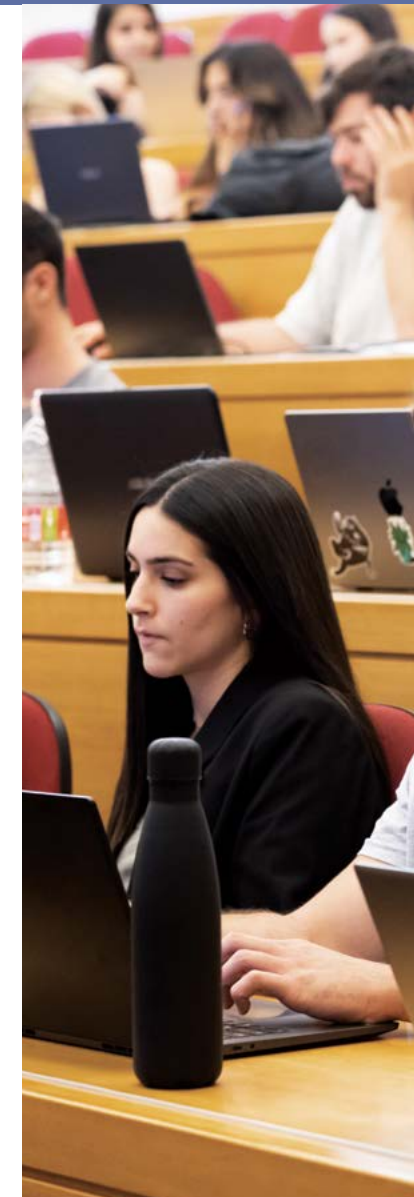

TERMS AND PAYMENTS

[Home Page](#)

[Welcome](#)

[Preparatory Courses](#)

[Orientation Week](#)

[Ulpan](#)

[Reichman University Dormitories](#)

[Health Insurance](#)

[Visa Information](#)

[Living in Israel](#)

[Terms of Payment and Fees](#)

[Scholarships and Financial Aid](#)

[Study Skills Center / Psych. Counseling](#)

[Contact Info](#)

[Academic Calendar](#)

[Final Checklist](#)

TERMS OF PAYMENT

Due Date	<ul style="list-style-type: none"> • Business Administration • Government • Government and Sustainability • Business and Economics 	<ul style="list-style-type: none"> • Communications • Computer Science • Entrepreneurship and Computer Science • Entrepreneurship and Business • Entrepreneurship and Economics with Data Science • Psychology 	Health Insurance in \$USD (if needed)
Down payment	\$1,000	\$1000	
Nov. 10, 2024	\$2,460 (including Student Union Fee**)	\$2,760 (including Student Union Fee**)	\$1,600**
Dec. 10, 2024	\$2,500	\$2,500	
Jan. 10, 2025	\$2,500	\$2,500	
Feb. 10, 2025	\$2,500	\$2,500	
Mar. 10, 2025	\$2,500	\$2,500	
April 10, 2025	\$2,500	\$2,500	
Total	\$15,960	\$16,260	\$1,600

* All sums are subject to change

** For information and registration please email RRIS.Insurance@runi.ac.il

*** For Student Union Benefits visit the [Student Union website](#)

If you do not wish to be a member of the Reichman University Student Union, you must notify the Reichman University Student Union and sign a concession form by December 18, 2024.

TERMS AND PAYMENTS

[Home Page](#)

[Welcome](#)

[Preparatory Courses](#)

[Orientation Week](#)

[Ulpan](#)

[Reichman University Dormitories](#)

[Health Insurance](#)

[Visa Information](#)

[Living in Israel](#)

[Terms of Payment and Fees](#)

[Scholarships and Financial Aid](#)

[Study Skills Center / Psych. Counseling](#)

[Contact Info](#)

[Academic Calendar](#)

[Final Checklist](#)

PAYMENTS OPTIONS

Tuition and fees can be paid either by **credit card**, or **wire transfer** to Reichman University bank account.

1. Paying by Credit Card

You may use the Online Payment Center with credit card for payments in **USD** or in **NIS** (according to the daily \$ exchange rate on the date of payment). A Payment in USD can be done in one installment only, for each payment. A payment in NIS can be done in one installment or in 3-18 credit payments. Interest rates are determined by the credit card company when paying in multiple installments.

Please enter: MyRUNI account → [Candidate Info Station](#) → Finance → payments → make payment here.

2. Paying via wire transfer (bank details)

Beneficiary	Reichman University (CC)
Bank	12 Hapoalim Bank
Branch	628 Herzliya Branch
Account No.	244144
Swift Code	Poalilit
IBAN	IL90-0126-2800-0000-0244-144

After each transaction, please send us the transaction document indicating the student's name and ID number either by fax +972-9-9527640 or e-mail to izakr@runi.ac.il.

Please note:

- A period of one week is necessary in order to receive confirmation of wire transfers.
- Students may only pay 10% of their annual tuition fee in cash, in accordance to the Israeli law which restricts the use of cash.
- Should a payment be made in NIS, the value in USD will be determined according to the exchange rate on the day that the payment is received
- There may be an extra charge by the bank when wiring a payment. Students are responsible for paying any extra fees that may be deducted by the bank.

It is the student's responsibility to make all payments on time

TERMS AND PAYMENTS

[Home Page](#)

[Welcome](#)

[Preparatory Courses](#)

[Orientation Week](#)

[Ulpan](#)

[Reichman University Dormitories](#)

[Health Insurance](#)

[Visa Information](#)

[Living in Israel](#)

[Terms of Payment and Fees](#)

[Scholarships and Financial Aid](#)

[Study Skills Center / Psych. Counseling](#)

[Contact Info](#)

[Academic Calendar](#)

[Final Checklist](#)

SCHOLARSHIPS OR OTHER FUNDING SOURCES

Students who are considered new immigrants must update the Student Authority with their academic status in order to receive the Student Authority (“Minhal Hastudentim”) grant. Should a student receive any scholarship, grant or other form of funding, he/she must contact the Reichman University Tuition Department in order to receive a revised payment plan.

ADDITIONAL INFORMATION

1. Reichman University reserves the right to make changes to all the above-mentioned terms and regulations, without personally notifying all those concerned.
2. Tuition rates and additional fees are subject to change by Reichman University at its discretion, any time prior to the beginning of studies.
3. **Students who do not settle their payments for tuition, health insurance and dorms on time, will be limited on their access to their Moodle and their student information center.**

ADDITIONAL EXPENSES

Students are responsible for their airfare to and from Israel.

Please note, tuition doesn't include the cost of the textbooks that we recommend students to purchase.



TERMS AND PAYMENTS

[Home Page](#)

[Welcome](#)

[Preparatory Courses](#)

[Orientation Week](#)

[Ulpan](#)

[Reichman University Dormitories](#)

[Health Insurance](#)

[Visa Information](#)

[Living in Israel](#)

[Terms of Payment and Fees](#)

[Scholarships and Financial Aid](#)

[Study Skills Center / Psych. Counseling](#)

[Contact Info](#)

[Academic Calendar](#)

[Final Checklist](#)

TUITION REGULATIONS FOR STUDENTS WHO TERMINATE THEIR STUDIES

A student who has registered at Reichman University for the 2024-2025 academic year, has paid the down payment, and subsequently decides not to study during the current academic year, must submit an official statement in writing (via letter, e-mail, or fax) to both the RRIS Admissions Office and to the Reichman University Tuition Department. **A phone call will not be considered an official notification. The student must confirm the receipt of the notification.**

The calculation of tuition will be according to the date of official statement of cancellation in accordance with the table below.

Notice of termination of studies	Payment to be charged
By July 22, 2024	No charge
July 23, 2024 - August 11, 2024	25% of the down payment
August 12, 2024- September 12, 2024	50% of the down payment
September 13, 2024 - October 6, 2024	75% of the down payment
October 7, 2024 - November 3, 2024	100% of the down payment
November 4, 2024 - February 3, 2025	50% of the tuition fee
February 4, 2025 - March 24, 2025	66% of the tuition fee
From March 25, 2025	100% tuition fee

Freezing of studies is treated as a **cessation of studies** initiated by a student and students are charged according to the termination of studies table above.

Notification of cancellation or freezing of studies at any date will result in the cancellation of the student's entitlement to a scholarship or discount, which will be cancelled retroactively.

TERMS AND PAYMENTS

[Home Page](#)

[Welcome](#)

[Preparatory Courses](#)

[Orientation Week](#)

[Ulpan](#)

[Reichman University Dormitories](#)

[Health Insurance](#)

[Visa Information](#)

[Living in Israel](#)

[Terms of Payment and Fees](#)

[Scholarships and Financial Aid](#)

[Study Skills Center / Psych. Counseling](#)

[Contact Info](#)

[Academic Calendar](#)

[Final Checklist](#)

TUITION DEPARTMENT RECEPTION HOURS

Sun. - Thurs. 10 AM - 1 PM
 3 PM - 4 PM

TUITION DEPARTMENT CONTACT INFORMATION

Simona Hadad	shadad2@runi.ac.il	+972-9-9527-311
Nathalie Burstein	nathalie.burstein@runi.ac.il	+972-9-9527-916
Ronit Izak	izakr@runi.ac.il	+972-9-9527-627
Meital Ezra	meital.ezra@runi.ac.il	+972-9-9527-256
Sharon Kupferberg	Sharon.kupferberg@runi.ac.il	+972-960-2961
General	tuition@runi.ac.il	Fax +972-9-9527640

REICHMAN UNIVERSITY DORMS

For information, registration, please visit the Reichman University Dorms [website](#).
 The Reichman University Dorms are a separate entity and therefore students who cancel or freeze and had registered for the dorms, must contact the dorms staff in writing at dorms@runi.ac.il

[Click here for the most up-to-date Tuition Fees and Terms of Payment information.](#)



SCHOLARSHIPS AND FINANCIAL AID

[Home Page](#)

[Welcome](#)

[Preparatory Courses](#)

[Orientation Week](#)

[Ulpan](#)

[Reichman University
Dormitories](#)

[Health Insurance](#)

[Visa Information](#)

[Living in Israel](#)

[Terms of Payment
and Fees](#)

[Scholarships and
Financial Aid](#)

[Study Skills Center /
Psych. Counseling](#)

[Contact Info](#)

[Academic Calendar](#)

[Final Checklist](#)

There are various scholarships and grants available to our students.

We recommend that you check what scholarships or grants are available in your country for studies abroad. For further assistance, please contact **Annette Behrendt-van Zeeland** or **Lisa Sharon**, from the Financial Aid Department, at rris.financialaid@runi.ac.il

RRIS SCHOLARSHIP

The Raphael Recanati International School offers a needs-based scholarship. The application will be available online [here](#).

First year students can apply until **November 1st 2024**. Students will be asked to provide information in regard to their needs and to attach relevant documents (pay stubs, bank statements, apartment lease etc.). Israeli citizens residing in Israel for more than five years (army not included) cannot apply for this scholarship but may apply for the RUNI scholarship through the Dean of Students' office at gzvi@runi.ac.il

JEWISH TOURIST

Jewish tourists between the ages of 18-30 who have not been in Israel on a prior long-term program are eligible for grants and scholarships through the Masa Project. Please note: once you make *Aliyah* you are not eligible for this grant so please check this out before making *Aliyah*! More information and application forms at: www.masaisrael.org

NEW IMMIGRANTS (*olim hadashim*)

New immigrants starting their BA studies before the age of 27 and within 36 months of making *Aliyah* are eligible for a grant from the Israeli government spread out over two and a half years (plus an additional half year grant with community

service). Please see [here](#) for more information. If you are in Israel, you can contact the *minhal hastudentim* directly at

tastudents@moia.gov.il

Please contact the RRIS absorption team at levys@runi.ac.il for any additional questions you may have.

FORMER IDF SOLDIERS

Please inform us via e-mail if you apply to any of these funds:

1. IMPACT - Socio-economic based scholarships for former combat and combat-support soldiers, up to the rank of captain and up to three years of career service, who have completed a full and proper military service within four years before the beginning of their studies. This fund provides a three-year scholarship in the amount of \$4,000 USD per year. First and second year students may apply within three years of their army release date. Registration from March 1 until May 31 on the web: www.fdfmpact.org

2. HESEG - Former Lone Soldiers, within two years of release date from the IDF, are eligible for a scholarship of full tuition and monthly allowance. This is the army's merit scholarship given prior to the first academic year and is for a period of three years. Registration from March 1 until June 30 on the web: www.heseg.com

SCHOLARSHIPS AND FINANCIAL AID

[Home Page](#)

[Welcome](#)

[Preparatory Courses](#)

[Orientation Week](#)

[Ulpan](#)

[Reichman University Dormitories](#)

[Health Insurance](#)

[Visa Information](#)

[Living in Israel](#)

[Terms of Payment and Fees](#)

[Scholarships and Financial Aid](#)

[Study Skills Center / Psych. Counseling](#)

[Contact Info](#)

[Academic Calendar](#)

[Final Checklist](#)

COUNTRY OF ORIGIN

→ **ISRAEL** Students born and raised in Israel should contact Galit Zvi, Head of the Scholarship Department, at gzvi@runi.ac.il for information regarding available scholarships.

→ **USA** Citizen students may apply for a Free Application for Federal Student Aid (FAFSA) loans and/or Sallie Mae loans. They may be eligible for Direct Stafford Loans (Subsidized, Unsubsidized and Plus loans) as part of the Direct Loans program of the US Department of Education. As a foreign school, our students are not eligible for FAFSA grants or Pell. Our School Code is G40703 and our school name is Raphael Recanati International School. Students can fill out their 2024-2025 FAFSA application starting December 2023: www.fafsa.ed.gov. For Consumer Information (process, school code, policies, and regulations) see [here for our 23-24 brochure](#). Please contact Rina Haller by email at rina@aforu.org with questions and to start the process. We do not automate FAFSA loans, students must contact Rina if interested in borrowing loans. Loan packages for students for 2024-2025 will not be processed until Summer 2024 and our deadline is April 1, 2025. Please note, that tuition, health insurance, and dorms fees can be paid with US COLLEGE FUNDS such as the 529 College Funds Plans, Florida prepaid funds, and other similar college funds. Please be directly in touch with the North American office by e-mail at rris.us@runi.ac.il.

For the full list of scholarships please go to:
[RRIS Undergraduate Financial Aid](#)

→ **SOUTH AFRICA** TELFED provides scholarship to South African students. Please contact: info@telfed.org.il You may also apply for the SAM COHEN Trust for South African students studying in Israel. More information and forms at: mail@papilsky.co.za

→ **HOLLAND** Students who emigrated from the Netherlands to Israel or have at least one parent/grandparent who immigrated to Israel from the Netherlands may apply. Application online is available from the beginning of the academic year until the end of December at: www.milga-nl.org.il

→ **CANADA** SAP (Students Assistance Programs) offers loans and scholarships to Canadian students. [Financial aid](#) is also available through your province. For further information visit [here](#).

→ **DENMARK** The Danish-Israeli study Foundation offers scholarships for Danish citizens with permanent residency in Israel. The student will have to fill out an application [here](#).

→ **FINLAND** The Finnish government offers loans for Finnish students with very convenient terms. The student needs to apply directly to www.kela.fi

→ **GERMANY** The German government offers a monthly allowance. The student's parents need to apply directly. BAföG scholarship: <https://www.xn--bafg-7qa.de> & the ELES scholarship: www.eles-studienwerk.de

→ **SWEDEN** CSN offers 2/3 Loan and 1/3 Grant to Swedish students. The student needs to apply directly www.csn.se

THE LEA AND NAFTALI BEN-YEHUDA ACCESSIBILITY & STUDY SKILLS CENTER

[Home Page](#)

[Welcome](#)

[Preparatory Courses](#)

[Orientation Week](#)

[Ulpan](#)

[Reichman University Dormitories](#)

[Health Insurance](#)

[Visa Information](#)

[Living in Israel](#)

[Terms of Payment and Fees](#)

[Scholarships and Financial Aid](#)

[Study Skills Center / Psych. Counseling](#)

[Contact Info](#)

[Academic Calendar](#)

[Final Checklist](#)

The Lea and Naftali Ben-Yehuda Accessibility & Study Skill Center assists students recognized by the dean of students as students with learning issues and attention deficit disorders, students with physical, emotional, sensory, or cognitive disabilities, and students that are dealing with a temporary or permanent medical issue that has functional repercussions to studying.

Academic learning strategies:

Learning How To Learn - Free modular training units developed specifically for students at Reichman University. The training units are based on brain research and learning and provide practical tools for academic success.

Offering students best practices for both online and on campus studying.

Teaching learning skills – one on one:

Every student is welcome to enjoy one on one meetings with a professional teacher who specializes in learning strategies.

Academic accessibility counseling one on one:

Students with sensory, physical, or other disabilities caused by a chronic disease with direct implication on academic study abilities are invited to contact the academic accessibility coordinator, to schedule a personal meeting.

Accommodations and accessibility due to Medical Disabilities:

Every student can receive the accommodation they need, the applications are to be submitted by the date advertised on [web page](#) and in student announcements. We recommend submitting the application as soon as possible.

Students are most welcome to join activities during the semester. You can read more information in our [website](#).

For more information please refer to our [web page](#) or send an email to negishut@runi.ac.il or call us: +972-9-9602738



THE LEAH AND ITZHAK SHECHTER CENTER FOR PSYCHOLOGICAL COUNSELING SERVICES

[Home Page](#)

[Welcome](#)

[Preparatory Courses](#)

[Orientation Week](#)

[Ulpan](#)

[Reichman University Dormitories](#)

[Health Insurance](#)

[Visa Information](#)

[Living in Israel](#)

[Terms of Payment and Fees](#)

[Scholarships and Financial Aid](#)

[Study Skills Center / Psych. Counseling](#)

[Contact Info](#)

[Academic Calendar](#)

[Final Checklist](#)

The Center for Psychological Counseling Services provides interested students with the opportunity to receive help and support dealing with various problems and challenges that students may encounter during the period of their studies.

Students who apply to the center may receive **short-term counseling** or up to two semesters of ongoing therapy through personal meetings with professionals who have extensive experience treating students from a wide variety of cultures and backgrounds. Group meetings or workshops dealing with concerns relevant to students may also be available.

What are the most common problems for which students apply for counseling?

Students apply for personal counseling for a wide variety of reasons, which may include the following: culture shock or experiencing difficulty coping with the many challenges inherent in being in a new and unfamiliar environment; difficulties with school or job; struggling with personal or professional identity; social, interpersonal, or romantic difficulties; dealing with grief or loss; problems occurring in the family which have a stressful impact, such as illness, divorce, or financial crisis; feeling overly anxious or depressed; coping with attention deficit disorder and/or learning disabilities. These problems may be new to the student or may be issues from the past that are resurfacing or intensifying when students are far from home and/or feeling alone and isolated.

Sometimes due to a student's particular circumstances, he or she might be better served by seeing a professional in the community. In these cases, the student will receive help with an appropriate referral.

Students interested in booking an initial consultation are kindly requested to contact our administrative coordinator, tel.: +972-9-960-2872 email: psyhelp@runi.ac.il.

Please note that the Psychological Counseling Services are not equipped to provide long-term care for students who need continuous psychological or psychiatric support. Therefore, students dealing with ongoing mental health issues are strongly advised to set up a professional support system before coming to Israel. We are happy to provide more information about the various options if needed.

For more information regarding our services, please see our [website](#).

THE LEAH AND ITZHAK SHECHTER CENTER FOR PSYCHOLOGICAL COUNSELING SERVICES

[Home Page](#)

[Welcome](#)

[Preparatory Courses](#)

[Orientation Week](#)

[Ulpan](#)

[Reichman University Dormitories](#)

[Health Insurance](#)

[Visa Information](#)

[Living in Israel](#)

[Terms of Payment and Fees](#)

[Scholarships and Financial Aid](#)

[Study Skills Center / Psych. Counseling](#)

[Contact Info](#)

[Academic Calendar](#)

[Final Checklist](#)

EXAM ACCOMMODATIONS FOR LEARNING DISABILITIES/ADHD

Reasonable accommodations are provided by Reichman University to students who have been diagnosed with learning disabilities or attention deficit disorder. The accommodations are awarded to minimize as much as possible the negative effects that these difficulties can have on students' performance, while simultaneously maintaining the exam's reliability and validity. Therefore, the exam accommodations that the University provides are designed such that they do not alter the essential character of the exams, i.e., the scope of the material tested, or the essence of the exams' demands upon students (for example, comprehension, applying knowledge, etc.).

All students dealing with a learning disability and/or ADHD who wish to apply for exam accommodations must submit relevant documentation. International students dealing with a learning disability and/or ADHD must submit acceptable documentation according to the guidelines listed on our website, under [Students with Learning Disabilities](#). After the documentation has been submitted, a meeting with a psychologist from the Counseling Center will be scheduled where the eligibility for specific accommodations will be discussed. Documents must be submitted no later than five weeks before the end of the semester in order to guarantee the request will be processed in time for that semester's exams.

Students who finished high school in Israel and completed the Bagrut in Hebrew, who wish to receive accommodations, are obligated to submit a particular kind of diagnostic report called MATAL. Please make sure you get all the information about the MATAL evaluation process, how it works, who it applies to, and who might be exempt, by referring to the [Hebrew website](#).

CONTACT INFORMATION

Do not hesitate to contact us if you have any questions regarding the information in this booklet. Please note that our offices are closed on weekends which are Friday-Saturday in Israel.

Jonathan Davis
Vice President for External Relations
Head, Raphael Recanati International School
jonathand@runi.ac.il
+972-9-960-2714

Carine Katz
Director, Raphael Recanati International School
ckatz@runi.ac.il
+972-9-960-2806

Sarit Ben-Or
Program Coordinator
sbenor@runi.ac.il
+972-9-960-2771

Liron Tzour
Director of International Marketing
Liron.Tzour@runi.ac.il
+972-9-952-7261

Adaya Hoffman
International Marketing Coordinator
adaya.hoffman@runi.ac.il
+972-9-960-2752

Stephanie Miller
Head of Admissions at RRIS
smiller@runi.ac.il
+972-9-960-2841

Or Arfi
Deputy Head of Admissions
BA Communications
BA Psychology
Or.arfi@runi.ac.il
+972-9-960-2842

Delissa Fisher
Academic Admissions Officer
BA Government
BA Sustainability and Government Study Abroad
delissa.fisher@runi.ac.il
+972-9-960-2978

Emmanuelle Chemla
Academic Admissions Officer
BA Business Administration
BA Business & Economics
BA Entrepreneurship & Business
e.chemla@runi.ac.il
+972-9-9527391

Jessica Dana
Academic Admissions Officer
BSc Computer Science
BA Entrepreneurship & BSc Computer Science
BA Economics, Entrepreneurship with Data Science
Jessica.dana@runi.ac.il
+972-9-9527248

Natalie Golan-Aubrey
Director of Recruitment and Marketing, North America
rris.us@runi.ac.il
+1-212-213-5962

Rina Haller
Manager of Financial Aid, North America
Rina@afidc.org
+1-212-213-5961

[Home Page](#)

[Welcome](#)

[Preparatory Courses](#)

[Orientation Week](#)

[Ulpan](#)

[Reichman University Dormitories](#)

[Health Insurance](#)

[Visa Information](#)

[Living in Israel](#)

[Terms of Payment and Fees](#)

[Scholarships and Financial Aid](#)

[Study Skills Center / Psych. Counseling](#)

[Contact Info](#)

[Academic Calendar](#)

[Final Checklist](#)

CONTACT INFORMATION

[Home Page](#)

[Welcome](#)

[Preparatory Courses](#)

[Orientation Week](#)

[Ulpan](#)

[Reichman University Dormitories](#)

[Health Insurance](#)

[Visa Information](#)

[Living in Israel](#)

[Terms of Payment and Fees](#)

[Scholarships and Financial Aid](#)

[Study Skills Center / Psych. Counseling](#)

[Contact Info](#)

[Academic Calendar](#)

[Final Checklist](#)

STUDENT AFFAIRS & WELL-BEING

Sylvia Kassoff

Director of Student Affairs and Well-being

sylvia@runi.ac.il

+972-9-960-2420

Shelly Levy

Student Affairs Senior Advisor

levys@runi.ac.il

+972-9-960-2880

Kineret Benjamin

Student Affairs Advisor

kineret.benjamin@runi.ac.il

+972-9-952-7657

Anni Lupu

RRIS Campus Life Events Manager

anni.lupu@runi.ac.il

+972-9-960-2794

Annette Behrendt-van Zeeland

Financial Aid Manager

abehrendt@runi.ac.il

+972-9-952-7962

Lisa Sharon

Financial Aid Coordinator

Lisa.sharon@runi.ac.il

+972-9-960-2719



CONTACT INFORMATION

[Home Page](#)

[Welcome](#)

[Preparatory Courses](#)

[Orientation Week](#)

[Ulpan](#)

[Reichman University Dormitories](#)

[Health Insurance](#)

[Visa Information](#)

[Living in Israel](#)

[Terms of Payment and Fees](#)

[Scholarships and Financial Aid](#)

[Study Skills Center / Psych. Counseling](#)

[Contact Info](#)

[Academic Calendar](#)

[Final Checklist](#)

RRIS STUDENT ADMINISTRATION

The Student Administration Office provides a variety of services to students concerning the administrative aspect of their academic studies and handles all academic matters: grades; registration for courses; credits; and records of studies.

Communication with the administration is through your [candidate/student info station](#).



ACADEMIC CALENDAR 2024-2025

[Home Page](#)

[Welcome](#)

[Preparatory Courses](#)

[Orientation Week](#)

[Ulpan](#)

[Reichman University Dormitories](#)

[Health Insurance](#)

[Visa Information](#)

[Living in Israel](#)

[Terms of Payment and Fees](#)

[Scholarships and Financial Aid](#)

[Study Skills Center / Psych. Counseling](#)

[Contact Info](#)

[Academic Calendar](#)

[Final Checklist](#)

Orientation week	27.10.2024
Fall semester begins	3.11.2024
Memorial Day for Yitzchak Rabin Z"l	TBA
Hanukkah vacation	29.12.2024
Fall semester ends	31.1.2025
Fall exams begin	2.2.2025
Spring Semester begins	23.3.2025
Passover vacation	7-20.4.2025
Studies resume	21.4.2025
Eve of Holocaust Memorial Day	23.4.2025
Holocaust Memorial Day ceremony	24.4.2025
Israel Memorial Day Ceremony	29.4.2025
Eve of Israel Memorial Day	29.4.2025
Israel Memorial Day	30.4.2025
Israel Independence Day	1.5.2025
Memorial Day ceremony for Ethiopian Jews who perished on their way to Israel	TBA
Shavuot vacation	1-2.6.2025
Graduation ceremony (2023)	TBD
Honorary Fellowship & Outstanding Researchers and Lecturers ceremony	TBD
Student day	TBD
Spring semester ends	4.7.2025
Spring exams begin	6.7.2025
Summer semester begin	TBA
Logistics weekend	TBA
Summer semester ends	TBA

Dates are subject to change.



ACADEMIC CALENDAR

[Home Page](#)

[Welcome](#)

[Preparatory Courses](#)

[Orientation Week](#)

[Ulpan](#)

[Reichman University
Dormitories](#)

[Health Insurance](#)

[Visa Information](#)

[Living in Israel](#)

[Terms of Payment
and Fees](#)

[Scholarships and
Financial Aid](#)

[Study Skills Center /
Psych. Counseling](#)

[Contact Info](#)

[Academic Calendar](#)

[Final Checklist](#)

FALL SEMESTER CONCLUSION, EXAM SCHEDULE AND POTENTIAL FOR TIME OFF

Exams begin immediately following the conclusion of fall semester. In accordance with traditional Israeli higher education models, RUNI offers students the opportunity to take a first sitting of exams (“*moed aleph*”) generally during the first four weeks between semesters. Students will receive their *moed aleph* exam schedule at the beginning of the semester. If a student fails the *moed aleph* exam, is not happy with the grade or had to miss the exam due to unforeseen circumstances, he/she is entitled to sit for a second exam (“*moed bet*”). These second exams are scheduled immediately following the *moed aleph* exams. Therefore, each student has a highly individual schedule, very often with no vacation whatsoever between fall and spring semester dependent on 1) *moed aleph* schedule, assigned during the first week of the semester and 2) the student’s desire to be present for *moed bet*/retakes.

If you are certain that you will not need a retake, you can book your return ticket date upon receipt of your *moed aleph* exam schedule (following your final exam time). If you are booking a ticket to Israel and are concerned about choosing a return ticket date, we strongly urge you to purchase a “flexible fare” ticket that allows you to change your return date with no penalty fee. This will allow you to alter your date according to our exam schedule and need (or lack thereof) to sit for *moed bet* exams. While this class ticket is more expensive than a ticket with inflexible dates, it is significantly less expensive than altering the return date on an inflexible fare ticket if the need arises.

SPRING SEMESTER CONCLUSION, EXAM SCHEDULE AND EXTENDED BREAK

Exams begin immediately following the conclusion of spring semester. Students will receive their *moed aleph* exam schedule at the beginning of semester. As described above, following *moed aleph* exams students are entitled to sit for *moed bet* exams. Spring semester *moed bet* exams are generally scheduled through August. When students have concluded their exams (based on their highly personal schedule and desire to take *moed bet* exams), they are on semester break until mid-October when the next school year begins.

A FINAL CHECKLIST

[Home Page](#)

[Welcome](#)

[Preparatory Courses](#)

[Orientation Week](#)

[Ulpan](#)

[Reichman University Dormitories](#)

[Health Insurance](#)

[Visa Information](#)

[Living in Israel](#)

[Terms of Payment and Fees](#)

[Scholarships and Financial Aid](#)

[Study Skills Center / Psych. Counseling](#)

[Contact Info](#)

[Academic Calendar](#)

[Final Checklist](#)

- 1 Accept your admissions offer within the next 7 days
- 2 Update your personal details in the [candidate information station](#)
- 3 Confirm your acceptance by logging in to your [candidate information station](#) and paying the \$1,000 USD enrollment deposit (which will be credited towards your annual tuition payment)
- 4 If you request RUNI Dormitories, contact the dorms coordinator in the relevant section of this booklet
- 5 Share the important information in this booklet with your family.



Welcome to Reichman University - we're looking forward to meeting you!